

Ansicht  
M1 : 150

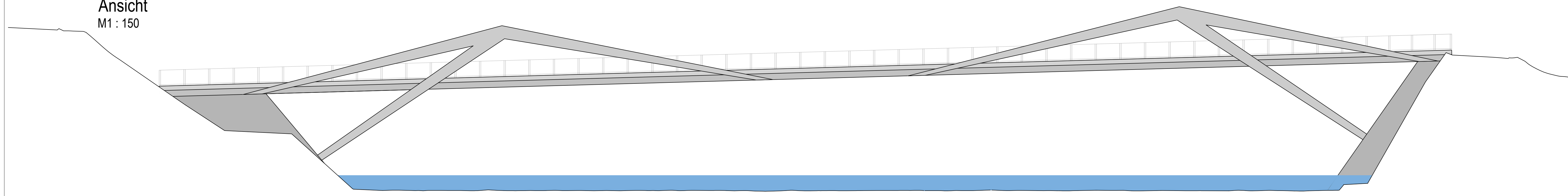

Schnitt A-A  
M1 : 150

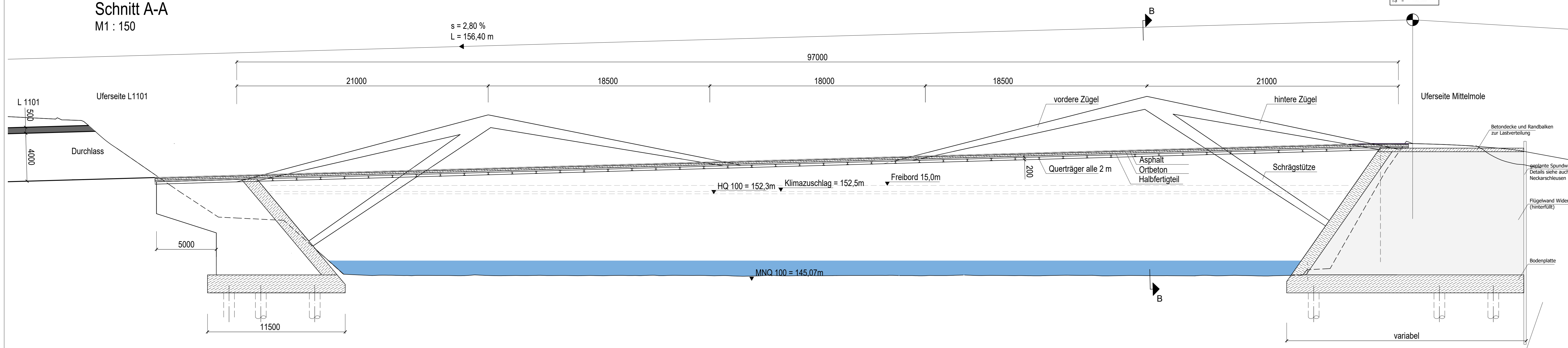

Schnitt B-B  
M1 : 50

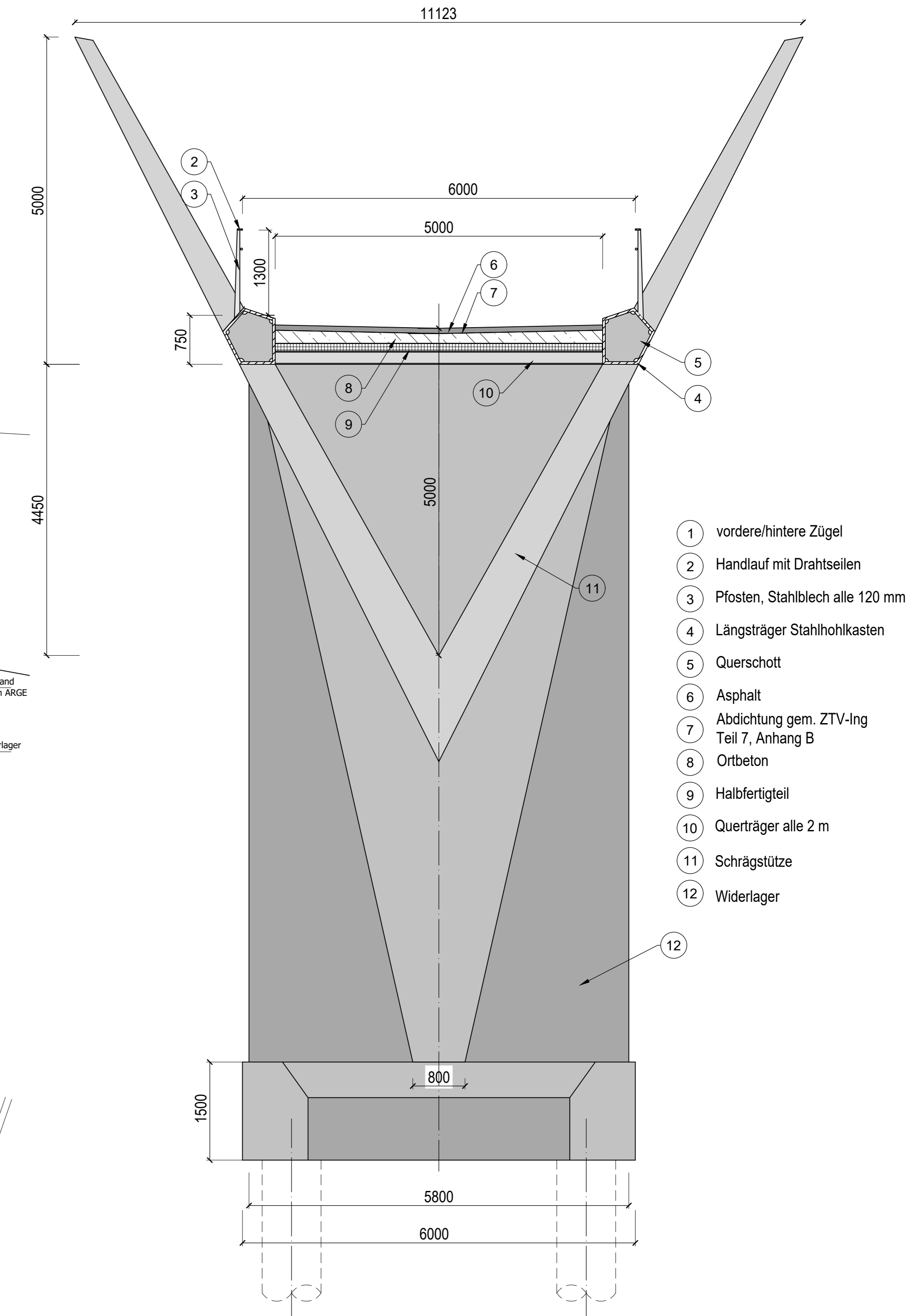

Grundriss  
M1 : 150

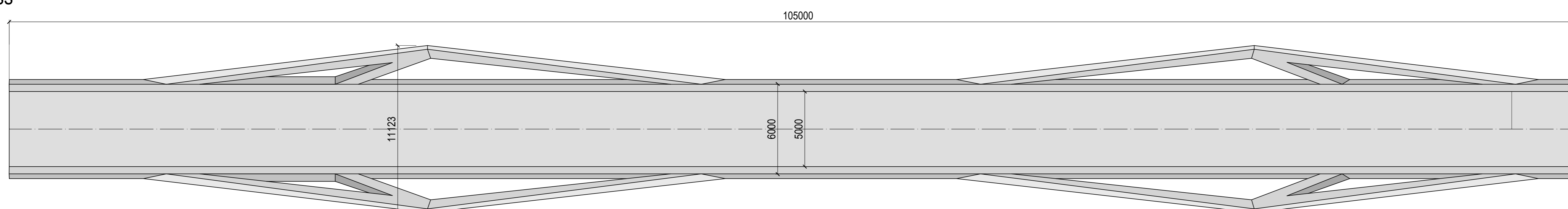

Lageplan  
M1 : 500

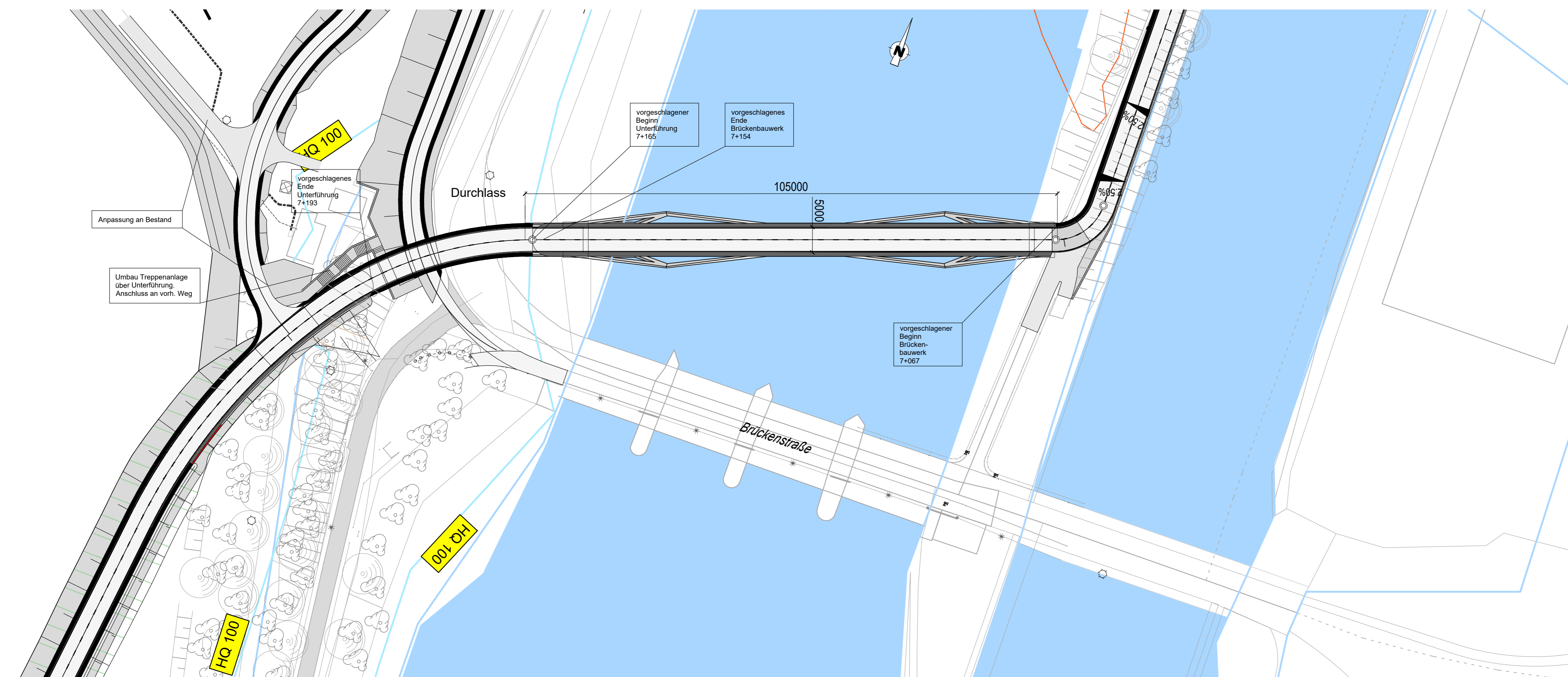

Isometrie

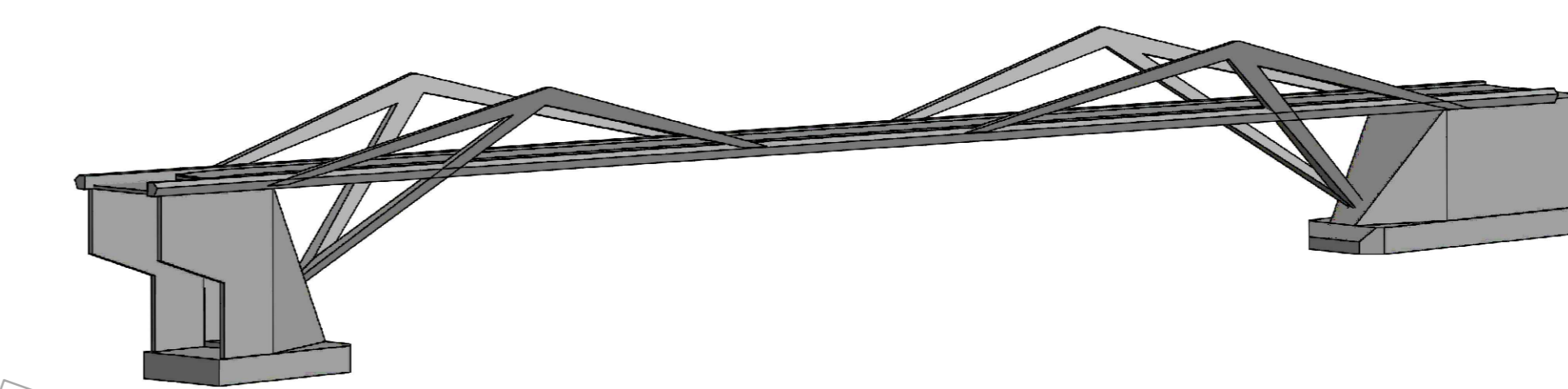

<p>Verfasser: _____</p> <p>Gezeichnet: _____</p> <p>Geprüft: _____</p> <p>Abgebillt: _____</p> <p>Änderung: _____</p>		<p>Projekt: 03579</p> <p>Bearbeitet: J. Weber 13.06.2022</p> <p>Gezeichnet: B. Rühniker 13.06.2022</p> <p>Geprüft: A. Kell 13.06.2022</p> <p>Unterschied: _____</p> <p>Stuttgart, den: _____</p>
<p>Bauherr: <b>Regierungspräsidium Stuttgart</b></p> <p>Projekt: <b>RS3 Bad Wimpfen - Heilbronn</b></p> <p>Bauwerk: <b>BW 08 - Radwegbrücke am Wehr</b></p>		
<p>Ansicht/Längsschnitt Grundriss Querschnitt</p>		<p>Phase: <b>Vorplanung</b></p> <p>Datum: <b>13.06.2022</b></p> <p>Maßstab: <b>1:150/50</b></p> <p>Plan-Nr.: <b>001</b></p> <p>Index: <b>01</b></p>
<p>Titel: <b>03579-220426_ruhn Neckarsulm ACAD.dwg</b></p>		

All rights reserved. No part of this drawing may be reproduced or transmitted in any form or by any means without written permission of the copyright holder.